

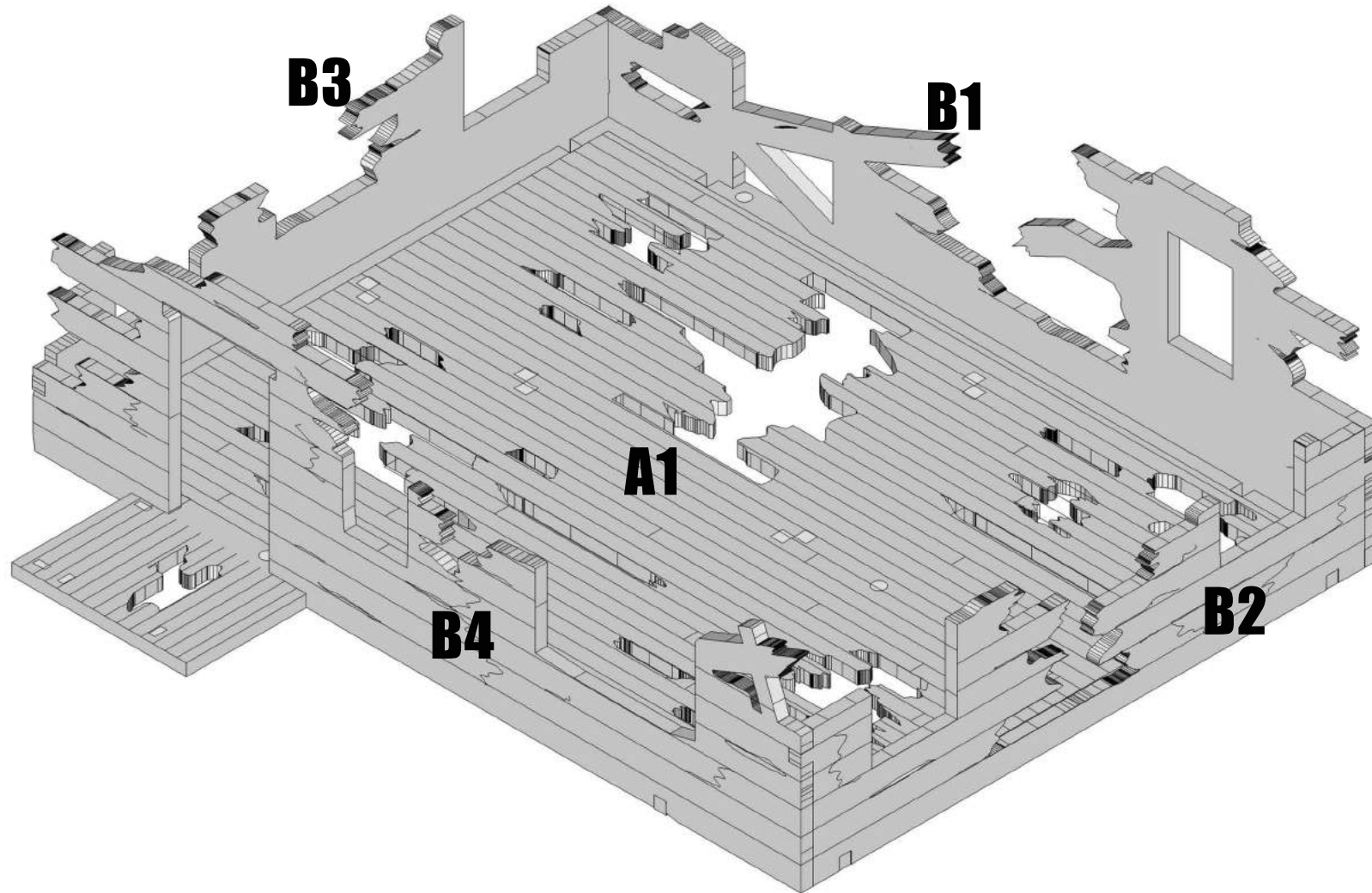

THE BURNS RESIDENCE





THE BURNS RESIDENCE

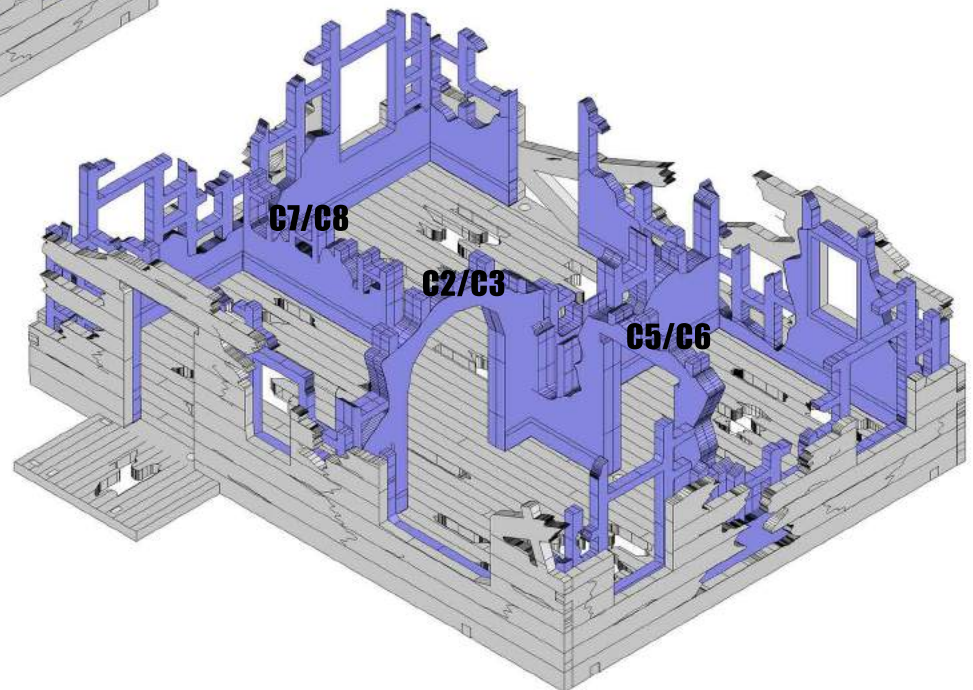
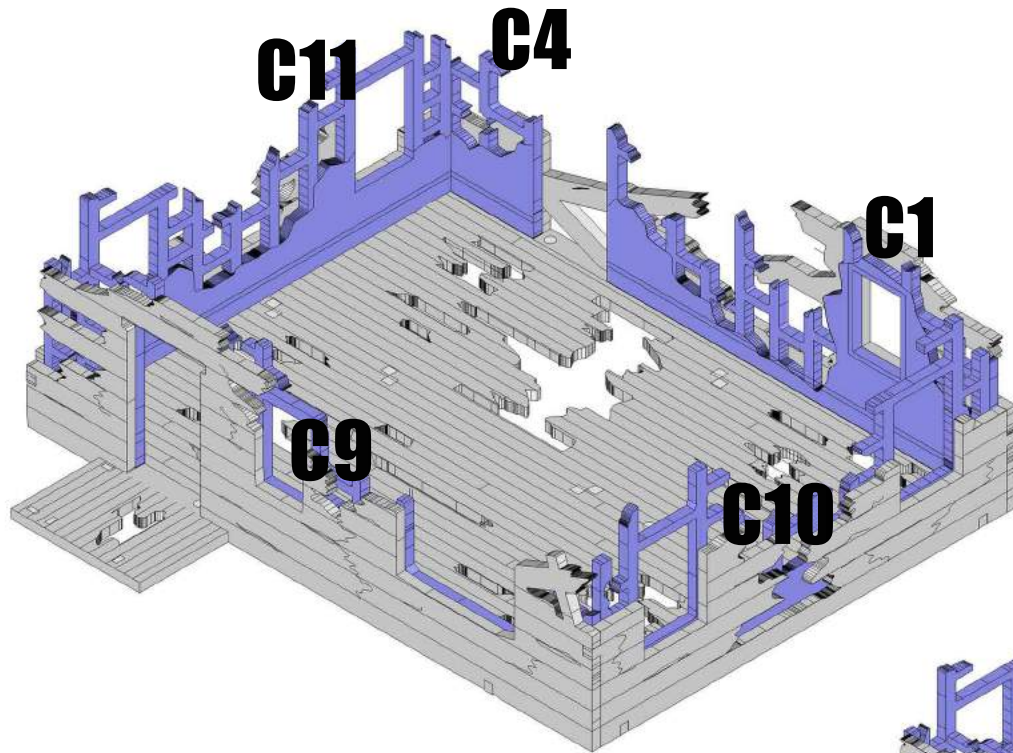



THE BURNS RESIDENCE

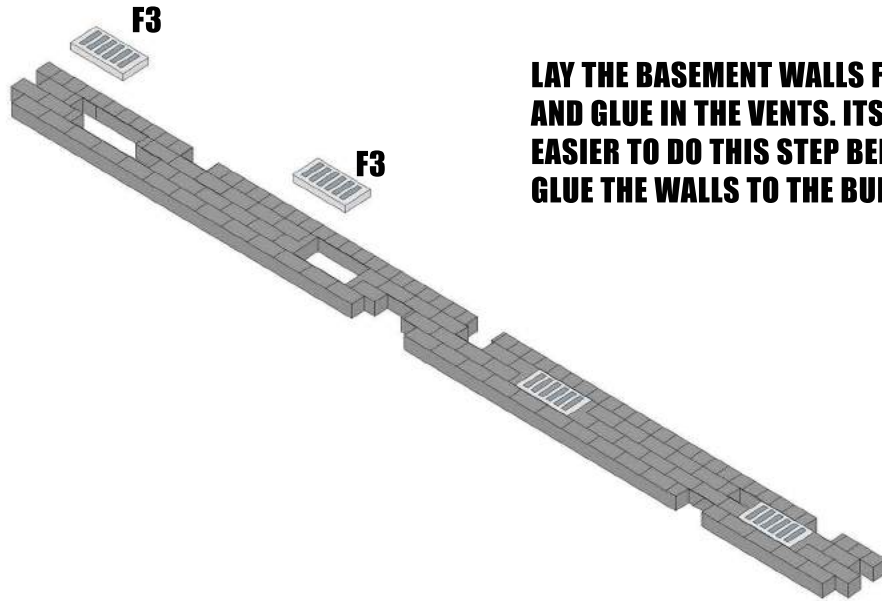

**LAY THE BASEMENT WALLS FLAT
AND GLUE IN THE VENTS. ITS MUCH
EASIER TO DO THIS STEP BEFORE YOU
GLUE THE WALLS TO THE BUILDING.**

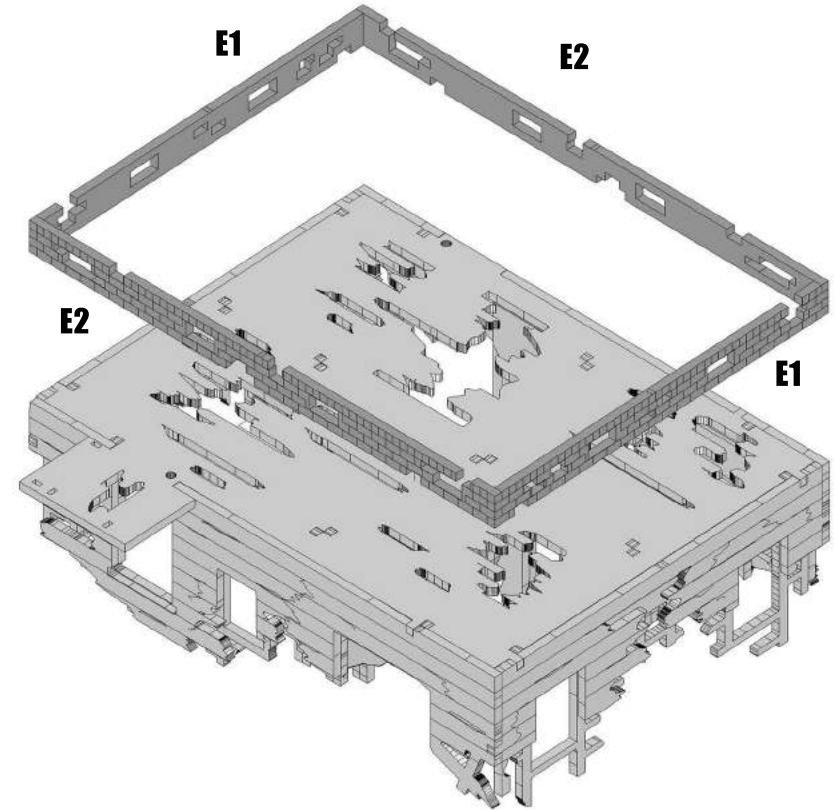



THE BURNS RESIDENCE

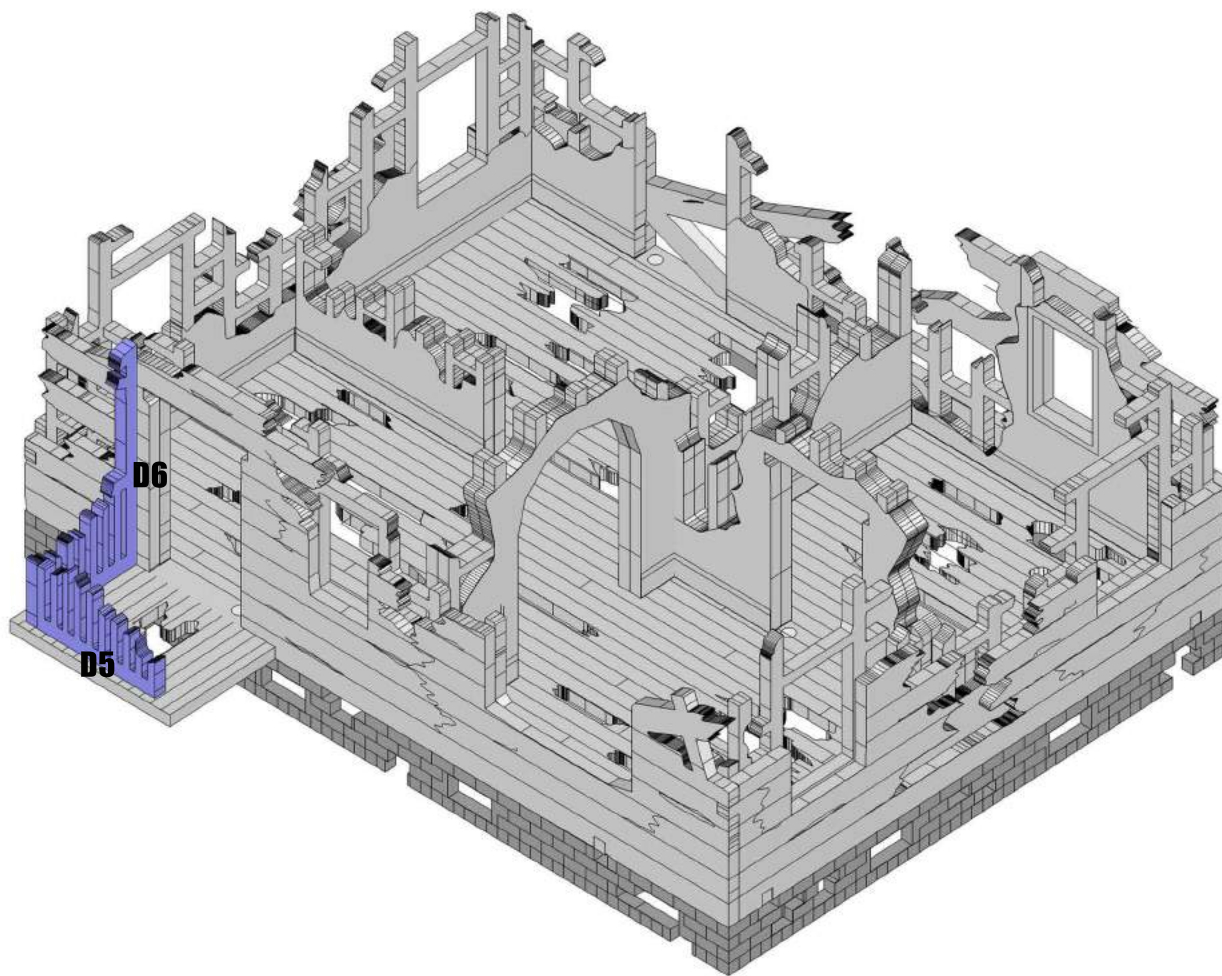



THE BURNS RESIDENCE

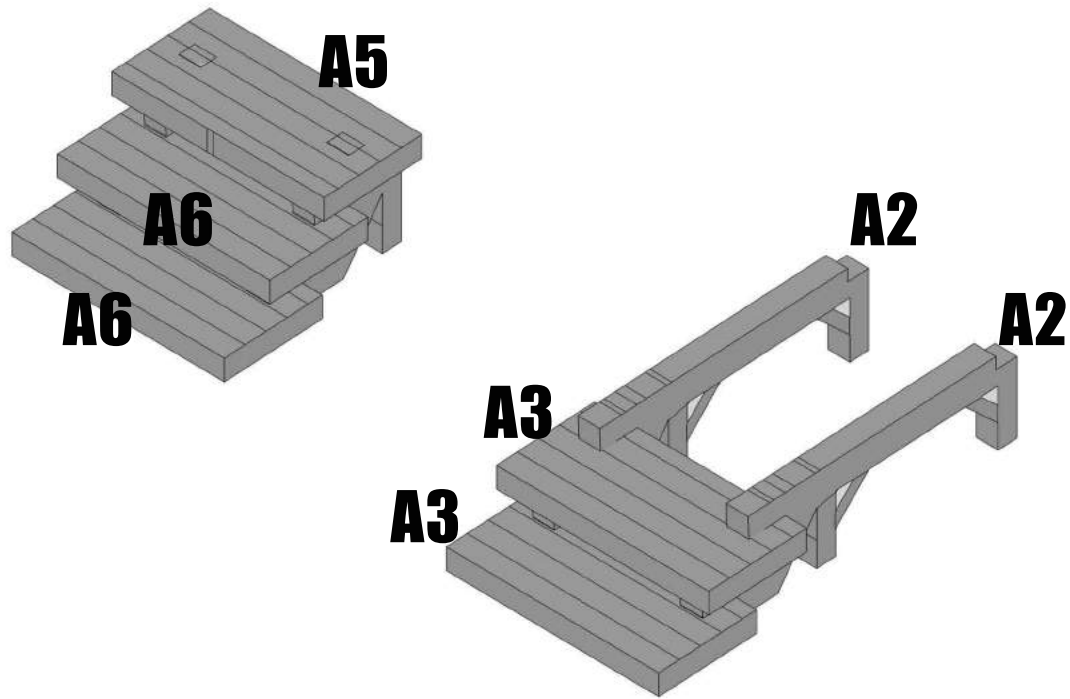



THE BURNS RESIDENCE

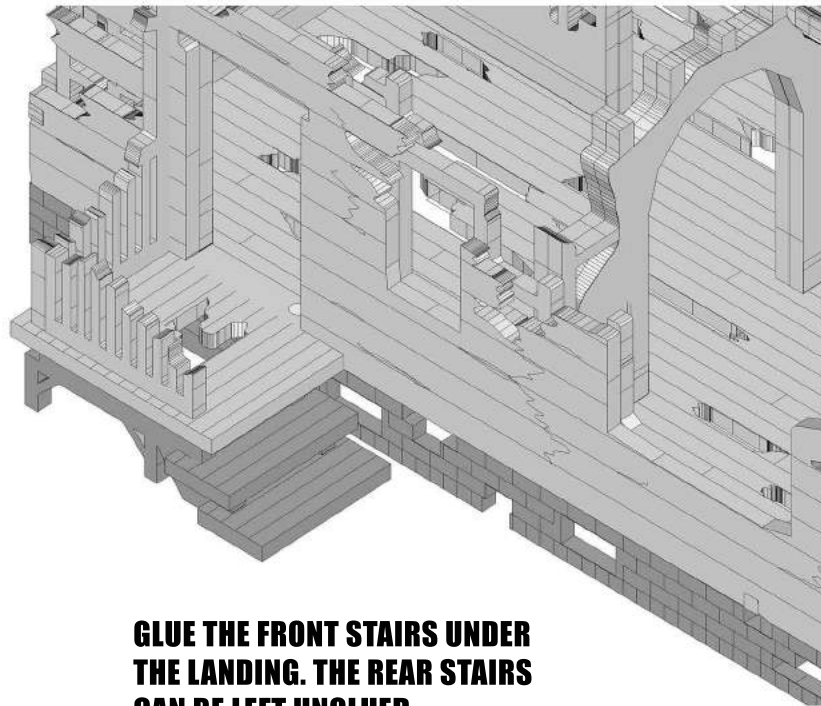

GLUE THE FRONT STAIRS UNDER THE LANDING. THE REAR STAIRS CAN BE LEFT UNGLUED.

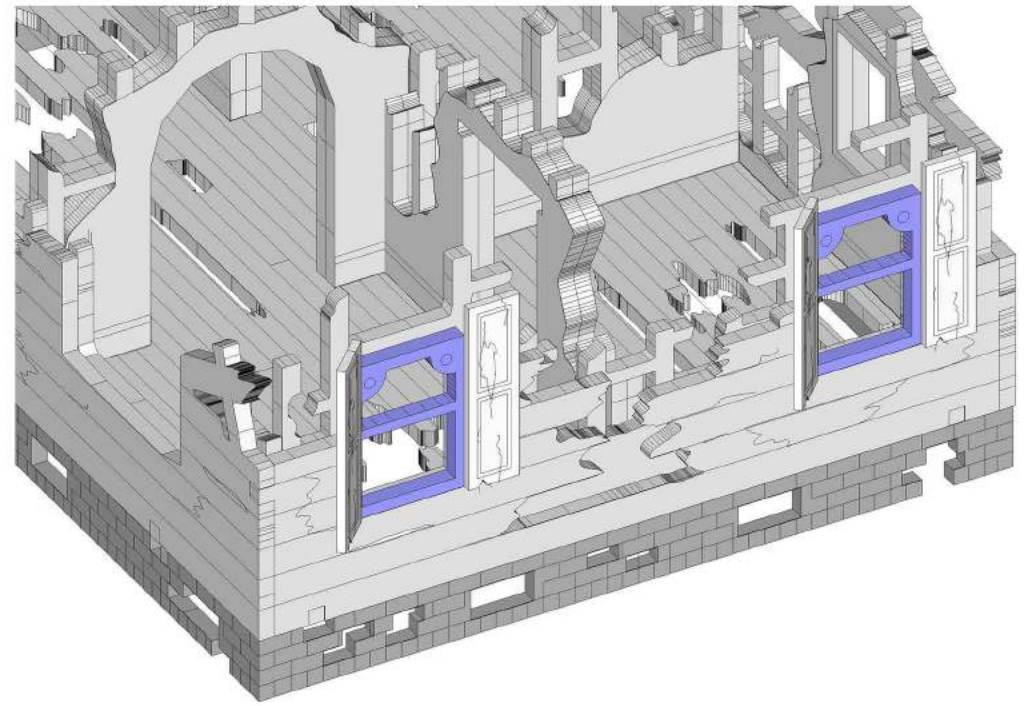

GLUE THE VARIOUS WINDOWS INTO THEIR RESPECTIVE HOLES. WE ALSO HAVE INCLUDED SOME SHUTTERS. YOU'LL GET A BETTER RESULT WITH THIS STEP IF YOU DO IT IN A RANDOM FASHION. DONT BE AFRAID TO BREAK THEM OR CUT THEM UP.